

DATA SHEET - HL2024 Inline 1P 15mm

Pressure independent flow controller. Ensures optimal flow control.



Figure number: 1140

Product overview

Optimal flow control

The HL2024 Inline creates a constant flow through its unique property of pressure independence. As such it ensures savings, optimal user comfort and system stabilisation. Installed into the piping towards both inlets of mixer taps, the product significantly reduces temperature fluctuations.

Certified constant flow

HL2024 products are pressure independent and as such provide a constant flow as certified by Kiwa, Netherlands (BRL-K635). The products meet the requirements for Kiwa Water Mark and primary European drinking water standards. All HL2024 products contain one or more integrated HL2024 Flow Controller(s). HL2024 is uniquely certified for pressure independence and long term operation.

Application

In the piping or connected to a flexible water hose.

Key properties

- Optimal flow control as a result of constant flow
- Optimal water temperature stability
- Definition of peak volume demand
- Water- and energy savings
- System stabilisation
- System pressure loss reduction

Top left: HL2024 Inline 1P 15mm

Bottom right: HL2024 Inline 1P 15mm incl. compression fittings - dimensions (in mm)

Specifications

Mounting: into the piping and/or to a flexible water hose
Connection in-/outlet: G 1/2" (BSP) male x 15mm for compression fittings
Total length excl. compression fittings: 51.4 mm
Total length incl. compression fittings: ± 69.0 mm
Thread length in-/outlet (incl. thread undercut): 11.0 mm
Widest point: 26.5 mm
Weight (excl. compression fittings): 71 g
Housing material: brass (4MS)
Finish outside: none
Finish water contact area: n/a
Max. particle size: 400 μm
Max. operating temperature: 90 °C *

Flow rate versions

5.0 l/min (150-1.000 kPa/dyn)
7.8 l/min (200-1.000 kPa/dyn)

Constant flow: pressure independent

Flow deviation within mentioned dynamic pressure range: max. 2%. **
The graph shows the constant flow performance of HL2024 products.

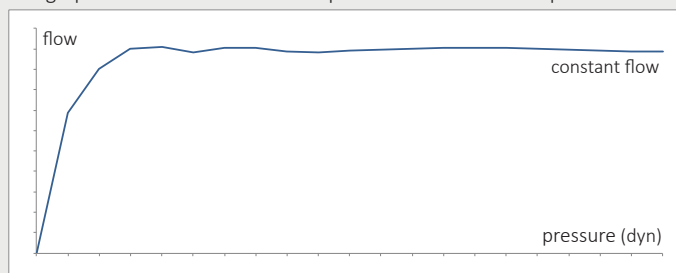

* In case of permanent or semi-permanent use at 500 kPa/dyn or more combined with 60 °C or more, please contact us at info@hl2024.com.

** Counter-pressure in the system might somewhat influence the flow rate.

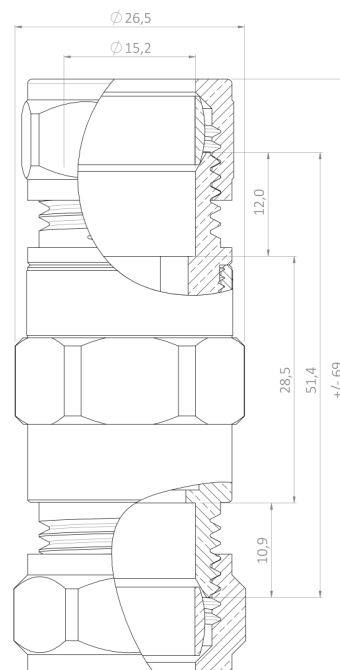

Disclaimer: HGP International aim to provide correct and up to date information at all times. HGP International, or companies belonging to its group, are not liable for possible consequences of any incorrect information provided in this document by mistake. HGP International reserve the right to make changes.

Note: later versions of this document replace and void older versions. The general terms and conditions of HGP International are applicable. In the general terms and conditions HGP International has limited its liability. Current versions of this document and of the general terms and conditions of HGP International are available at www.hl2024.com.